

**SOLD**

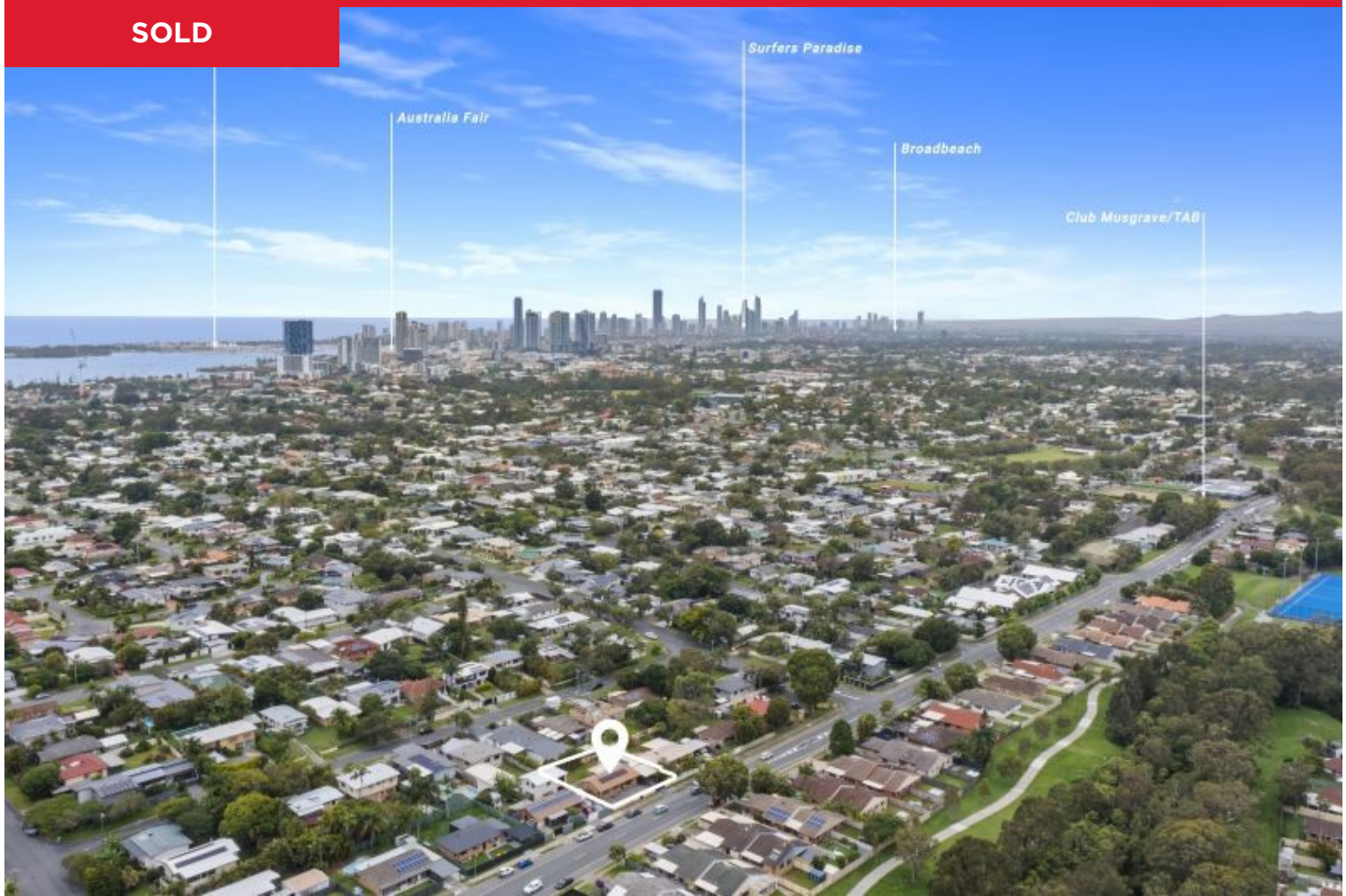

## 133 Kumbari Avenue, Labrador

WORK FROM HOME OPPORTUNITY AND PLENTY OF OFF STREET ADDITIONAL PARKING.

Conveniently located just a short walk to Chirn Park's many cafes, restaurants, bars and shops - with Griffith University, Hospitals, G-LINK Light rail, The Broadwater, Schools and Australia Fair Shopping Centre close by.

- \* Fully tiled open plan living and dining area - Air conditioned.
- \* Tidy kitchen with stone bench tops.
- \* 3 bedrooms all with built in robes and fans.
- \* Master bedroom with ensuite and air conditioning.
- \* 2 bathrooms....

...

3 2 6

**Price:** \$790,000

**View:** <https://remaxpropertycentre.com.au/6732083>

**Danny Woolbank**

**M 0414 946 127**



**KB Seo**

**0431 142 818**



RE/MAX Property Centre

Shop 6/110 Monaco Street

07 5629 7735



Ground Floor

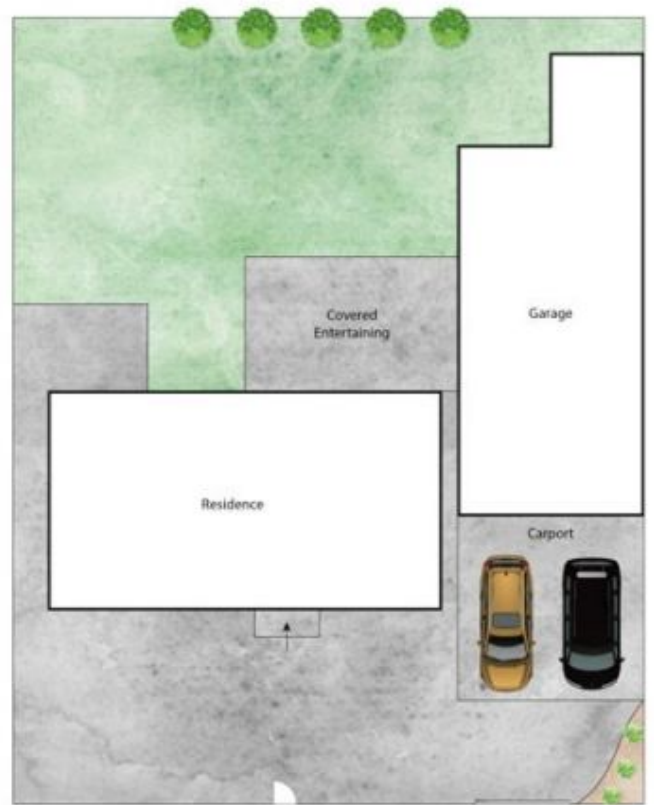

Site Plan

Approx Internal Area: 91m<sup>2</sup>  
 Approx Garage Area: 81m<sup>2</sup>  
 Approx Land Area: 601m<sup>2</sup>

Whilst Media Adobe has made every attempt to ensure the accuracy of the floor plan contained here, measurements are approximate and no responsibility is taken for any error, omission, or mis-statement. This plan is for illustrative purposes only.



133 Kumbari Avenue, Labrador